

HRH0926AVS HRH0826H

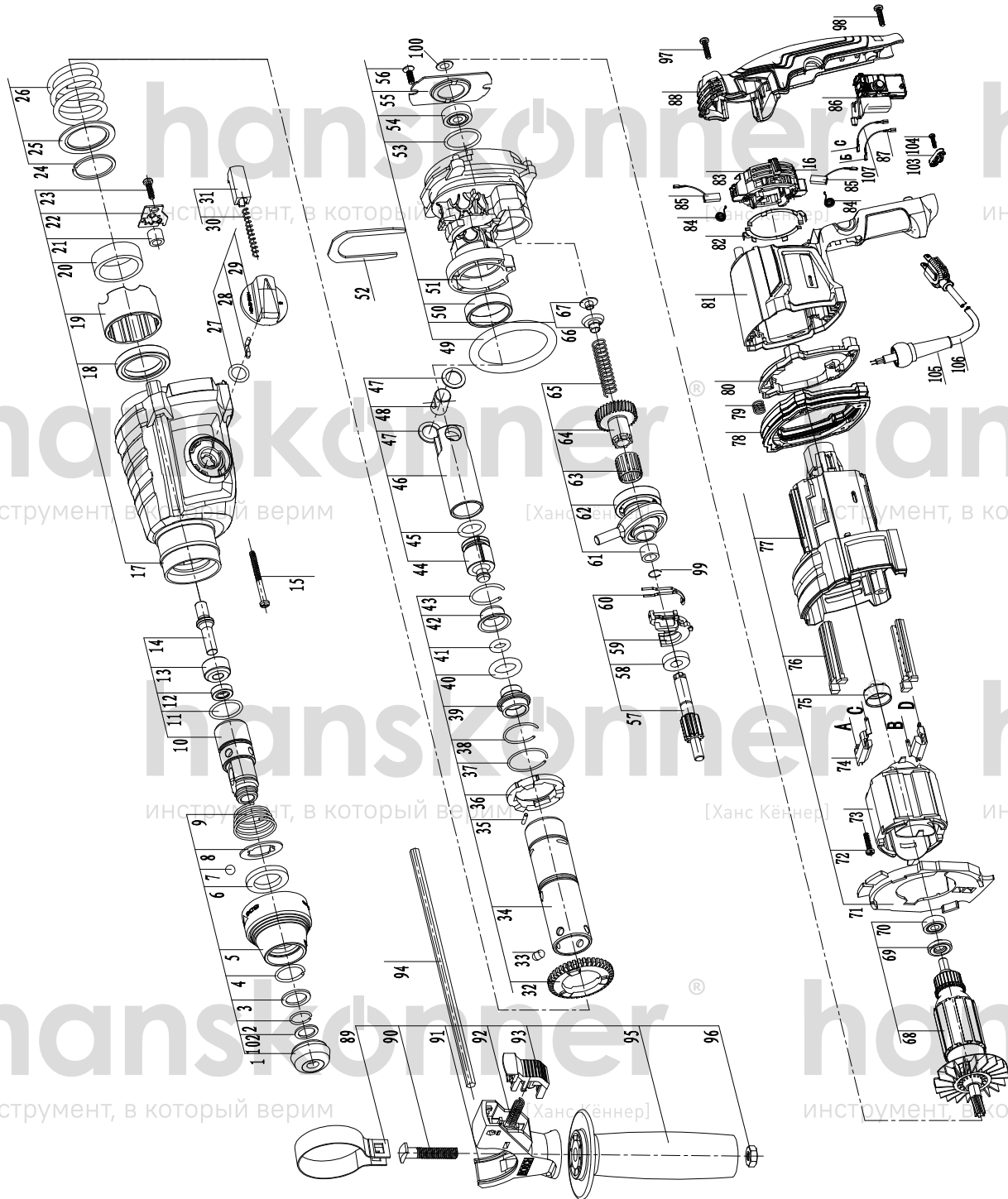

NO.	DESCRIPTION	NO.	DESCRIPTION
1	DUST CAP	54	BEARING 609Z
2	SNAP RING	55	BEARING PRESS PLATE
3	WASHER	56	SCREW
4	SNAP RING	57	GEAR SHAFT
5	LOCKING SLEEVE	58	BEARING 699Z
6	THICK WASHER	59	MODEL SELECTOR FORK
7	STEEL BALL	60	FORK SPRING
8	WASHER	61	NEEDLE ROLLER BEARING HK0908
9	SPRING	62	ROCKER BEARING
10	DRILL BIT COVER(TWO GROOVE)	63	NEEDLE ROLLER BEARING K15
11	SNAP RING	64	GEAR
12	OIL SEAL	65	SPRING
13	THRUST RING	66	SPRING HOLDER
14	STRIKER SHAFT	67	POSITION WASHER
15	SCREW ST4.5*40	68	ROTOR
16	SPRING	69	INSULATION WASHER
17	FRONT HOUSING	70	BEARING 627Z
18	OIL SEA	71	WIND GUIDE
19	BUSHING	72	SCREW ST3.5*14
20	NEEDLE ROLLER BEARING HK3012	73	STATOR
21	NEEDLE BEARING HK0709	74	INDUCTOR
22	NINE TEETH WASHER	75	BEARING BUSH
23	SCREW	76	GUIDING PART
24	FLAT SNAP RING	77	STATOR HOLDER
25	WASHER	78	ANTI-VIBRATION RUBBER PART
26	SPRING	79	SPRING
27	O-RING	80	SPRING SOCKET
28	MODEL SELECTOR POLE	81	MOTOR HOUSING
29	MODEL SELECTOR	82	COPPER CONTACT SHEET
30	SPRING	83	BRUSH HOLDER
31	LOCKING BUTTON	84	SPRING
32	BIG GEARING	85	CARBON BRUSH 5*8*19
33	STEEL BALL	86	POWER SWITCH
34	CONNECT PIPE	87	CONNECTING WIRE 98MM(M+M)
35	PIN	88	BACK COVER
36	CLUTCH DISK	89	CLAMPING BAND
37	SNAP RING	90	T SCREW
38	SNAP RING	91	SUPPORT CLAMP
39	GUIDE BUSH	92	SPRING
40	O-RING	93	LOCKING BUTTON
41	O-RING	94	DEPTH GAUGE
42	HOLDING JACKET	95	AUXILIARY HANDLE (RUBBER)
43	SNAP RING	96	NUT M8
44	PISTON	97	SCREW ST4.2*22
45	PISTON O-RING	98	SCREW ST4.2*16
46	CYLINDER	99	SNAP RING
47	CYLINDER PIN WASHER	100	WASHER
48	CYLINDER PIN	102	WASHER 11*17*1
49	O-RING	103	CORD CLAMP
50	HOLDER BUSHING	104	SCREW ST4*16
51	HOLDER	105	CORD SLEEVE
52	PRESS FORK	106	CABLE 4 M 2X01.0MM
53	O-RING	107	CONNECTING WIRE 100MM